



Google

© 2023 Google



22°26'31.3"N

88°26'16.2"E

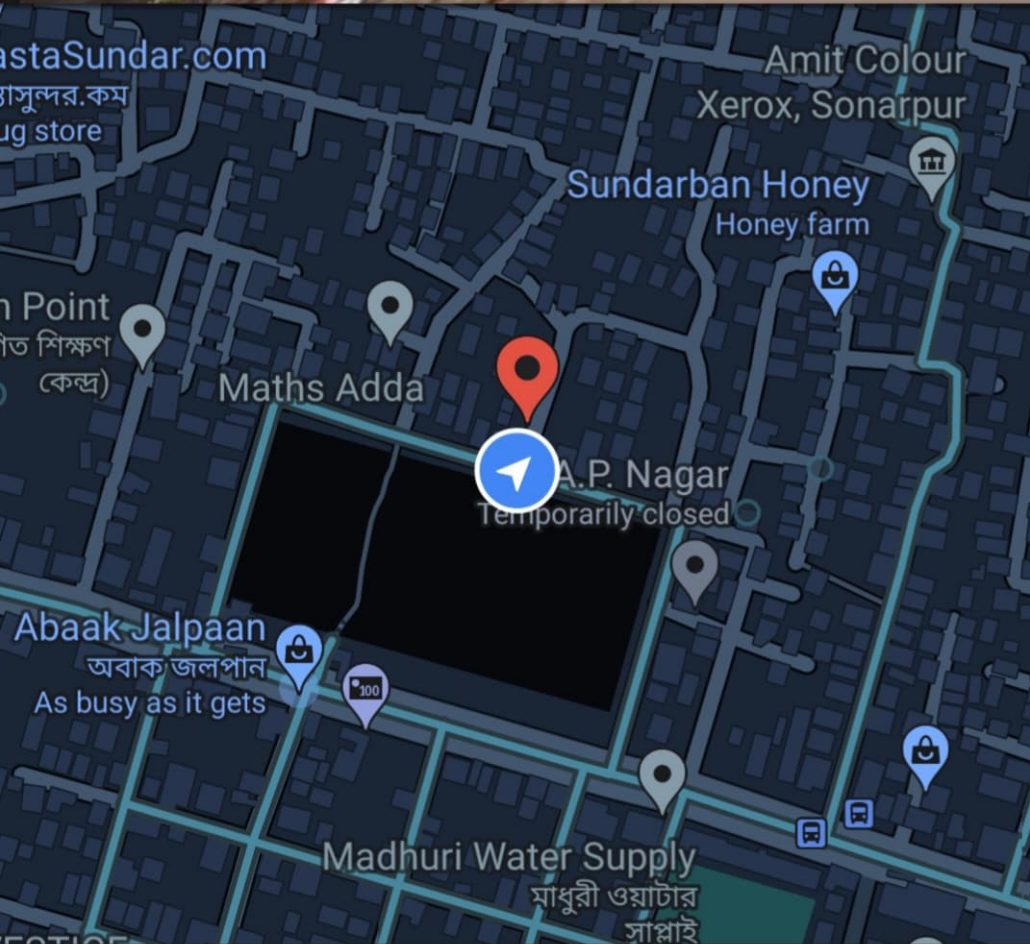

22°26'31.3"N 88°26'16.2"E

22.442038, 88.437831



**PLAN SHOWING THE LAND FOR SALE AT C.S. DAG NO. 1031,
R.S. DAG NO. 1085, L.R. DAG NO. 1085, C.S. KHT. NO. 290, R.S.
KHT. NO. 356, L.R. KHT. NOS. 6555, 6556, 6557, 6558, J.L. NO. 22,
OF MOUZA GORKHARA, P.S- SONARPUR, DIST.- SOUTH 24 PGS.
UNDER WARD NO. 11, HOLDING NO. 45, NAME OF ROAD -
GORKHARA - E, RAJPUR-SONARPUR MUNICIPALITY.**

SOLD AREA - 9kh. 7ch. 0sft. COL. IN RED BORDER
EXISTING SINGLE STORIED BUILDING AREA - 1080.00 SFT.

SCALE - 1" = 30'-0"

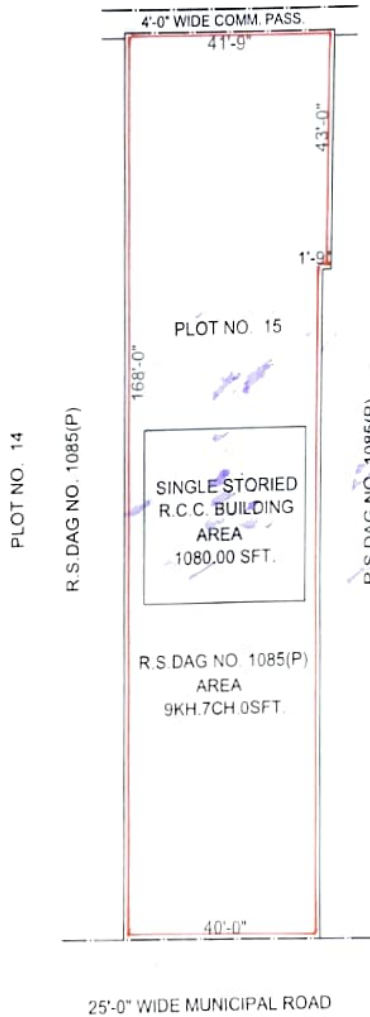

Mridul Mondal

Kanika Chakraborty

Juthika Biswas

Bhika Mondal

Signature of Vendors

Amal Chatterjee

Signature of purchaser

HABITAT
ENGINEERS & SURVEYORS
TAPAS DAS
OFFICE - GHADIARA, VIVEKANANDAPALLY
(OPPOSITE O.N.G.C. 2ND GATE)
SONARPUR, KOL-150
PH. NO - 2428 6241(R)
Mobile - 9831187369

20.15.11.22
HABITAT
ENGINEERS AND SURVEYORS
TAPAS DAS (LIC. No. 086) B.Sc. B Tech
E.B.S. Class-I, Rajpur-Sonarpur Municipality
SONARPUR MOBILE - 9831187369